

Method for Erecting Flats

You cannot erect a run of flats on your own; it requires at least 2 people to do it safely

Make sure you are wearing the correct Personal Protective Equipment:
Work boots or sturdy shoes are a minimum requirement.
You may also need to wear handling gloves and safety specs.

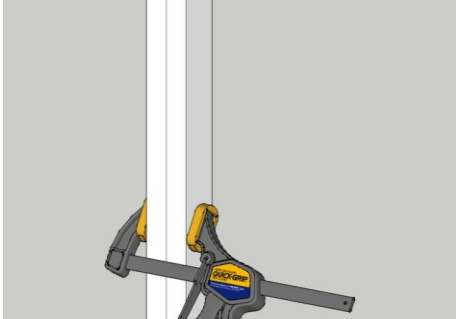

First stand the flats up and clamp them together, use clamps or your hands if they are strong.

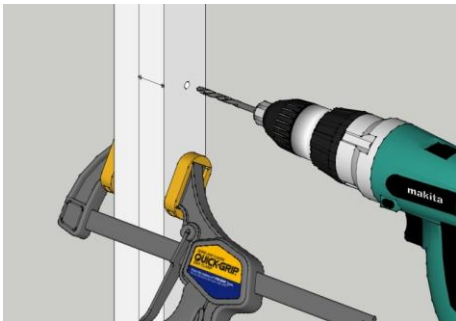

Next drill a 4mm clearance hole in one of the flats. (A clearance hole is one that does NOT grip the screw). This will allow it to pass through one flat and secure to the other. You will need to use 1 1/2" x 8 (also called 4 x 40mm) countersunk screws.

- Drill one hole at the top.....
- one in the middle
- and one at the bottom.....

If the flat is warped or twisted you may need more screws.

Remember: do not drill all the way through both flats, or the screw will not grip

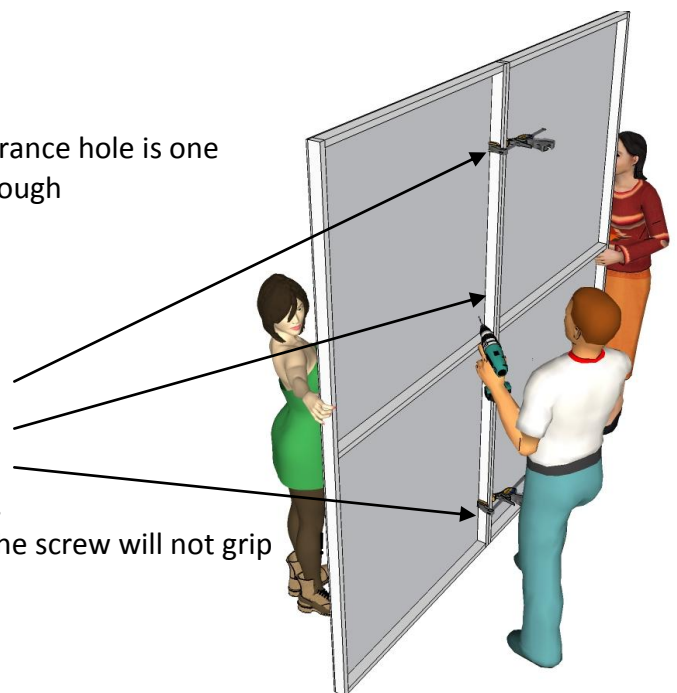
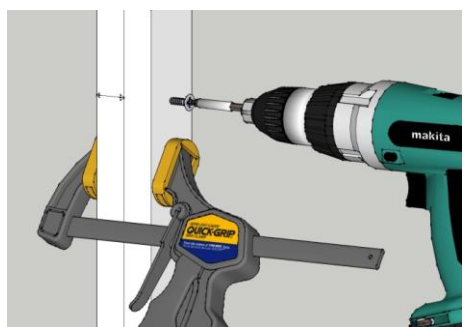

Now take out the 4mm drill bit and secure a screwdriver bit into the drill (or use a second drill with a driver bit already in it) then screw the flats together. The screw will pass easily through the first flat because you have drilled a clearance hole, but will grip in the second flat as it bites into the timber.